

OREGON PUBLIC LAND CORNER REPORT / RESTORATION REPORT  
Tillamook County Surveyor's Office

BOOK 8 232

SECTION: 9, 10, 15, & 16		TOWNSHIP: 2 South	RANGE: 10 West
COUNTY: Tillamook		DATE: 5/12/2025	
CORNER DESIGNATION:  The Section Corner common to Sections 9, 10, 15, and 16 Township 2 South, Range 10 West, Willamette Meridian		(Please check one)	
		Condition Report Only	
		Restoration	
		<input checked="" type="checkbox"/> Rewitness	
		Unrecorded	
		Reset at surface	
Referenced Out			
Previous Rewitnesses, Restorations and Surveys, etc... BLM-OREGON Field Note Volume: OR-R0053 Page: 397 (1857), B-983 (1981)			
History, condition, and sources: In 1857 (BLM field notes) a post was set for the corner, and four bearing trees were established. In 1981 (B-983) Robert Olsen found a ½" iron pipe set by Hendrickson, Berg, Imstad, Everly, and Corbett from found original bearing trees. In 2025 Tillamook County Surveyor's office found a ½" iron pipe as shown hereon. Found accessories are listed below.  Found: broken stump stub N01°W 17.8' (B-983 broken off stub 5' high with no face or scribe marks N01°W 17.8') Found: Debris pile S50°W 4.6' (B-983 rotting stump with old face evident but no scribing S50°W 4.6') Found: badly rotted stump S20°E 29.3' (B-983 stump with nail in face on root S20°E 29.3')			
New accessories set:  The monument was tied directly using GPS established control in Oregon North Zone NAD 83/91 grid coordinates in US Survey feet. Coordinates provided hereon are given in WGS 84 Latitude and Longitude.  Latitude: 45°24'22.46256" Longitude: -123°54'26.78972"  96" galvanized hat section post with yellow metal location tag South 1.0'  No new bearing trees suitable in the area.		Pictures of Found Monuments: 	
Location: ±450' East of forest service Rd. # 100			
Tillamook County Surveyor office: 1510 3 <sup>rd</sup> Street Suite C, Tillamook, OR. 97141		SURVEYOR'S SEAL	
Party Chief: Travis Porter, Tillamook County Survey Technician III		REGISTERED PROFESSIONAL LAND SURVEYOR	
Witnesses: Michael Rice P.L.S. 86926, Tillamook County Surveyor Kael Pokliuha, Tillamook County Survey Technician II			
Notes: Digital images taken of monument and accessories.		OREGON DECEMBER 11, 2012 MICHAEL R. RICE 86926	
		RENEWAL 12-31-2026	

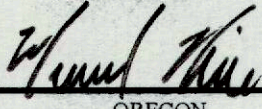
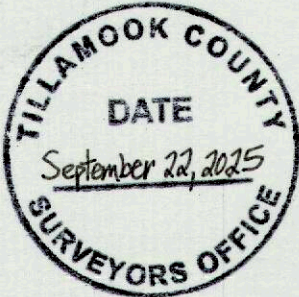

BOOK 8 232